

## How To Use Type Adapter with Prenco-Type® Kit Model No. 501

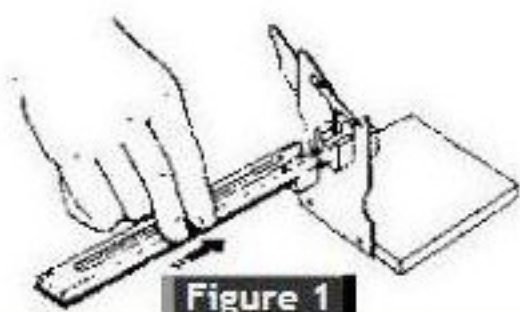

**Figure 1**

Adapter is attached to type cutting device by inserting pins into holes of adapter as shown in Figure 1.

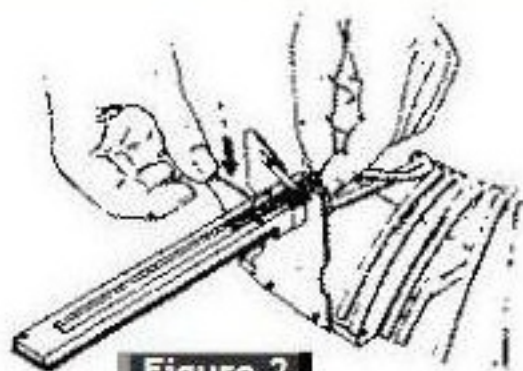
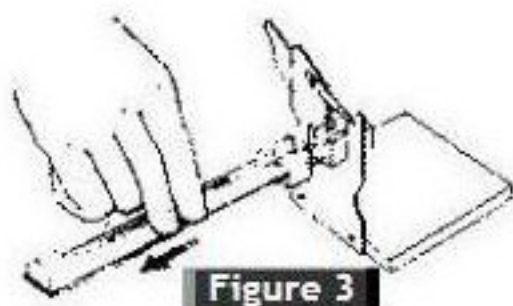

**Figure 2**

Type strip desired is inserted into "T" slot of cutting block, Figure 2, and moved forward until the space between letters is centered under cutting blade.

Press handle of cutting device downward severing letter or number, etc. from strip. Hold handle down and remove strip from cutting block.

Choose next type strip and repeat procedure, when line of text is completed push it well into adapter.



**Figure 3**

Remove adapter from cutting device

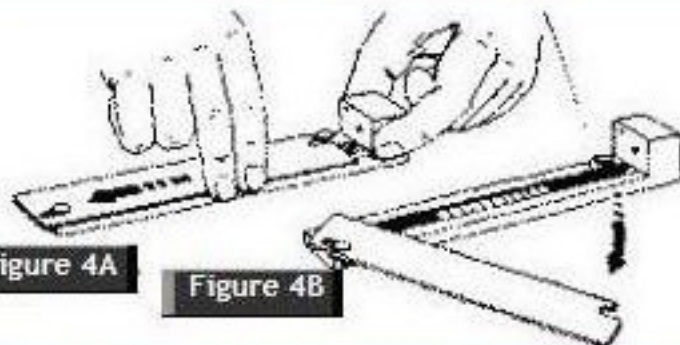

**Figure 4A**

**Figure 4B**

Lay adapter face down on a flat surface, Figure 4A.

Slide back and pivot the cover away from adapter to expose back side of type, Figure 4B.



**Figure 5**

Protective paper lined adhesive

Apply double side pressure sensitive tape to the special plastic type holder, cut tape off evenly at both ends of holder, then with knife, separate and peel off paperliner from adhesive, Figure 5.

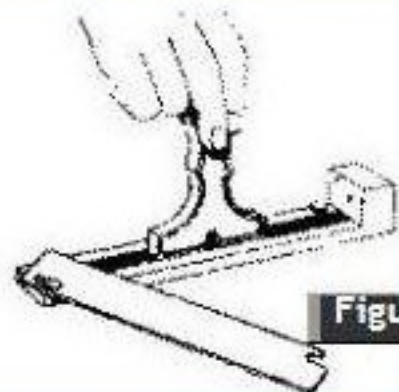

**Figure 6**

Slide and adjust type in adapter using scale provided for centering or line-up purposes.

Press prepared holder firmly down on type, Figure 6. Lift up holder with type adhered thereon. Stamp is now ready for use.



**Figure 7**

By snapping together the interlocking plastic holders, multiple line stamps can be made on the spot.

Note: Since multiple line stamps are made on individual holders, it is important to pick up type from adapter with the type holders facing in the same direction each time. This will avoid up-side-down lines in stamps.